

Allure[®]

Stored Product Moth Kit



GHS Signal word: Warning

Hazard statements: Causes serious eye irritation. Causes skin irritation. May cause respiratory irritation.

Precautionary Statements (Prevention): Wear protective gloves and eye/face protection. Use only outdoors or in a well-ventilated area.

Precautionary Statements (Response): Call a POISON CENTER or doctor/physician if you feel unwell. IF IN EYES: Rinse cautiously with water for several minutes. Remove contact lenses, if present and easy to do. Continue rinsing.

Precautionary Statements (Storage): Keep container tightly closed.

Precautionary Statements (Disposal): Dispose of contents/container to hazardous or special waste collection point.

CAS Number	Weight %	Chemical name
31654-77-0	93.0 %	9,12-Tetradecadien-1-ol, 1-acetate, (9E,12Z)-

Allure[®] Diamond Trap Assembly Instructions:

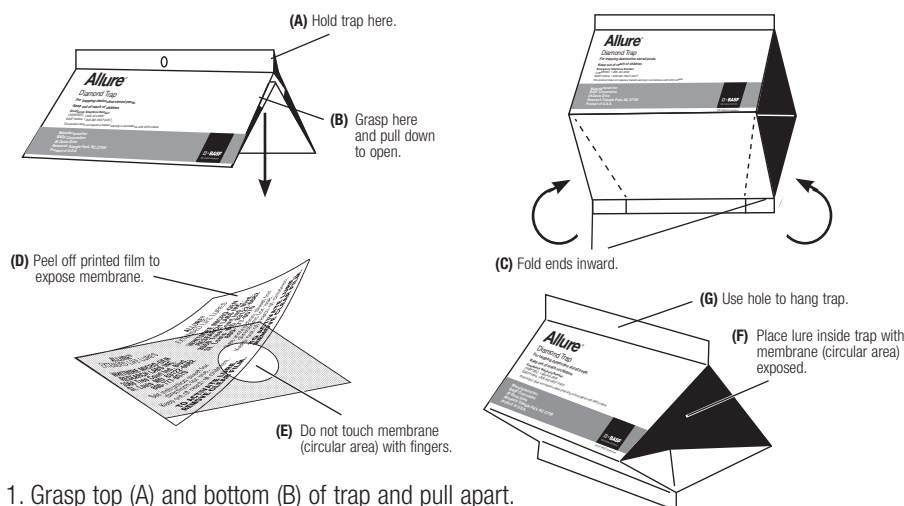

1. Grasp top (A) and bottom (B) of trap and pull apart.
2. Fold perforated ends (C) inward to hold the trap in three dimensional shape as shown.
3. Activate pheromone lure by peeling off printed film (D) to expose membrane (E). Do not touch exposed membrane with fingers.
4. Place the lure inside the trap on the glue, located under the top of the trap (F). To function properly, lures must be placed inside trap with membrane (circular area) facing away from glue.
5. Use the hole on top of trap (G) to hang in appropriate locations with wire or string.

NVA 2016-05-515-0663

Indian Meal Moth

Plodia interpunctella (Hubner)



(Lure attracts several related species: Almond Moth, Mediterranean Flour Moth, Raisin Moth, Tobacco Moth)

red peppers; seeds; shelled or ear corn; tobacco; and whole wheat or graham flour.

GEOGRAPHIC RANGE:

Worldwide

IDENTIFICATION:

Adult - All have narrow forewings and broad hind wings and labial palps which project forward forming a snout. Indian Meal Moths are 3/8 to 1/2 inch (10 to 13 millimeters) long with a wingspan of 3/8 to 3/4 inch (16 to 20 millimeters). Forewings are silver-grey, with outer two-thirds coppery brown; hind wings are dirty white. Other species are similar in appearance with grey mottled wings.

Larvae - Larvae of the different species are hard to distinguish, appearing dirty white; but may be yellow, pink, brown, or greenish depending on the food source.

LURE DURATION:

16 weeks

Manufactured for:
BASF Corporation
26 Davis Drive
Research Triangle Park, NC 27709
Product of U.S.A.

BASF
We create chemistry

Trap Placement and Use:

For monitoring, evenly space traps in a grid system. Use one trap per 30,000 cubic feet. Hang in appropriate locations with wire or string. Record trap counts on the BASF **Allure**® Monitoring Record form.

To find infestations within the facility, move traps from uninfested areas to the area where moths have been captured, increasing trap density to as much as one trap per 9,000 cubic feet. Close inspection in the area of maximum trap catch should reveal the infestation source.

Mass trapping can be accomplished with trap densities of one or more traps per 3,000 cubic feet, depending on the size of the moth population. Inspect traps weekly and remove insects and debris. Replace trap if insects, dust, or debris reduce stickiness. The pheromone lure lasts 16 weeks and can be removed and used on new traps.

Obtain further information and local recommendations from your state Agricultural Extension Service, local pest control company, or a consulting entomologist.

Note: To prolong storage life of the pheromone packet, refrigerate or freeze. Use tweezers or rubber gloves in handling to avoid contaminating packets when different **Allure**® products are being used. Do not damage the lure membrane by stapling, pinning or nailing the packet to the trap.

COMMODITIES ATTACKED:

Broken grain and grain products; biscuits; candy; chocolate; cocoa beans; cornmeal; crackers; dog food; dried fruits; nuts; powdered milk;

Conditions of Sale and Warranty

The **Directions For Use** of this product reflect the opinion of experts based on use and tests. The directions are believed to be reliable and must be followed carefully. However, it is impossible to eliminate all risks inherently associated with the use of this product. Ineffectiveness or other unintended consequences may result because of such factors as weather conditions, placement, presence of other materials, or use of the product in a manner inconsistent with its directions, all of which are beyond the control of BASF CORPORATION ("BASF") or the Seller. All such risks shall be assumed by the Buyer. BASF warrants that this product conforms to the chemical description on the label and is reasonably fit for the purposes referred to in the **Directions For Use**, subject to the inherent risks, referred to above. **BASF MAKES NO OTHER EXPRESS OR IMPLIED WARRANTY OF FITNESS OR MERCHANTABILITY OR ANY OTHER EXPRESS OR IMPLIED WARRANTY. BUYER'S EXCLUSIVE REMEDY AND BASF'S EXCLUSIVE LIABILITY, WHETHER IN CONTRACT, TORT, NEGLIGENCE, STRICT LIABILITY, OR OTHERWISE, SHALL BE LIMITED TO REPAYMENT OF THE PURCHASE PRICE OF THE PRODUCT. BASF AND THE SELLER DISCLAIM ANY LIABILITY FOR CONSEQUENTIAL, EXEMPLARY, SPECIAL OR INDIRECT DAMAGES RESULTING FROM THE USE OR HANDLING OF THIS PRODUCT.** BASF and the Seller offer this product, and the Buyer and User accept it, subject to the foregoing **Conditions of Sale and Warranty** which may be varied only by agreement in writing signed by a duly authorized representative of BASF.

NFR PCS714

1-800-832-HELP (4357) • pestcontrol.basf.us
© 2015 BASF Corporation. All rights reserved

Manufactured for:
BASF Corporation
26 Davis Drive
Research Triangle Park, NC 27709



We create chemistry



Safety Data Sheet

PT® 4 ALLURE

Revision date : 2009/12/23

Version: 1.0

Page: 1/7

(30487965/SDS_GEN_US/EN)

1. Product and Company Identification

Company

BASF CORPORATION
100 Campus Drive
Florham Park, NJ 07932, USA

24 Hour Emergency Response Information

CHEMTREC: 1-800-424-9300
BASF HOTLINE: 1-800-832-HELP

Registrant:

Whitmire Micro-Gen Research Laboratories, Inc.
3568 Tree Court Industrial Blvd.
St. Louis, MO 63122

Chemical family: pheromone

2. Hazards Identification

Emergency overview**CAUTION:**

KEEP OUT OF REACH OF CHILDREN.
KEEP OUT OF REACH OF DOMESTIC ANIMALS.
HARMFUL IF SWALLOWED.

Avoid contact with the skin, eyes and clothing.

Avoid inhalation of mists/vapours.

State of matter: liquid

Colour: colourless

Odour: mild

Potential health effects**Primary routes of exposure:**

Routes of entry for solids and liquids include eye and skin contact, ingestion and inhalation. Routes of entry for gases include inhalation and eye contact. Skin contact may be a route of entry for liquified gases.

Acute toxicity:

Relatively nontoxic after single ingestion. Slightly toxic after short-term skin contact. Relatively nontoxic after short-term inhalation.

Irritation / corrosion:

May cause slight but temporary irritation to the eyes. May cause moderate irritation to the skin.

Sensitization:

Skin sensitizing effects were not observed in animal studies.

Potential environmental effects

Safety Data Sheet

PT® 4 ALLURE

Revision date : 2009/12/23

Version: 1.0

Page: 2/7

(30487965/SDS_GEN_US/EN)

Aquatic toxicity:

Acutely toxic for fish. Acutely toxic for aquatic invertebrates. Very toxic (acute effect) to aquatic plants.

3. Composition / Information on Ingredients

CAS Number

31654-77-0

Content (W/W)

Chemical name

9,12-Tetradecadien-1-ol, 1-acetate, (9E,12Z)-

4. First-Aid Measures

General advice:

First aid providers should wear personal protective equipment to prevent exposure. Remove contaminated clothing. Move person to fresh air. If person is not breathing, call 911 or ambulance, then give artificial respiration, preferably mouth-to-mouth if possible. Call a poison control center or physician for treatment advice. Have the product container or label with you when calling a poison control center or doctor or going for treatment.

If inhaled:

Remove the affected individual into fresh air and keep the person calm.

If on skin:

Rinse skin immediately with plenty of water for 15 - 20 minutes.

If in eyes:

Hold eyes open and rinse slowly and gently with water for 15 to 20 minutes. Remove contact lenses, if present, after first 5 minutes, then continue rinsing.

If swallowed:

Never induce vomiting or give anything by mouth if the victim is unconscious or having convulsions. Do not induce vomiting. Have person sip a glass of water if able to swallow.

5. Fire-Fighting Measures

Flash point:

110 °C

(Tag closed cup)

Suitable extinguishing media:

foam, dry extinguishing media, carbon dioxide

Hazards during fire-fighting:

carbon monoxide,

If product is heated above decomposition temperature, toxic vapours will be released. The substances/groups of substances mentioned can be released in case of fire.

Protective equipment for fire-fighting:

Firefighters should be equipped with self-contained breathing apparatus and turn-out gear.

Further information:

Evacuate area of all unnecessary personnel. Contain contaminated water/firefighting water. Do not allow to enter drains or waterways.

6. Accidental release measures

Personal precautions:

Take appropriate protective measures. Clear area. Shut off source of leak only under safe conditions. Extinguish sources of ignition nearby and downwind. Ensure adequate ventilation. Wear suitable personal protective clothing and equipment.

Safety Data Sheet

PT® 4 ALLURE

Revision date : 2009/12/23

Version: 1.0

Page: 3/7

(30487965/SDS_GEN_US/EN)

Environmental precautions:

Do not discharge into the subsoil/soil. Do not discharge into drains/surface waters/groundwater. Contain contaminated water/firefighting water. A spill of or in excess of the reportable quantity requires notification to state, local and national emergency authorities. This product is not regulated by CERCLA ('Superfund').

Cleanup:

Dike spillage. Pick up with suitable absorbent material. Spilled substance/product should be recovered and applied according to label rates whenever possible. If application of spilled substance/product is not possible, then spills should be contained, solidified, and placed in suitable containers for disposal. After decontamination, spill area can be washed with water. Collect wash water for approved disposal.

7. Handling and Storage

Handling

General advice:

RECOMMENDATIONS ARE FOR MANUFACTURING, COMMERCIAL BLENDING, AND PACKAGING WORKERS. PESTICIDE APPLICATORS & WORKERS must refer to the Product Label and Directions for Use attached to the product. Provide good ventilation of working area (local exhaust ventilation if necessary). Keep away from sources of ignition - No smoking. Keep container tightly sealed. Protect against heat. Handle and open container with care. Do not open until ready to use. Once container is opened, content should be used as soon as possible. Provide means for controlling leaks and spills. Follow label warnings even after container is emptied. The substance/ product may be handled only by appropriately trained personnel. Avoid all direct contact with the substance/product. Avoid contact with the skin, eyes and clothing. Avoid inhalation of dusts/mists/vapours. Wear suitable personal protective clothing and equipment.

Protection against fire and explosion:

The relevant fire protection measures should be noted. Fire extinguishers should be kept handy. Avoid extreme heat.

Storage

General advice:

Keep only in the original container in a cool, dry, well-ventilated place away from ignition sources, heat or flame. Protect containers from physical damage. Protect against contamination. The authority permits and storage regulations must be observed.

Storage incompatibility:

General advice: Segregate from incompatible substances. Segregate from foods and animal feeds. Segregate from textiles and similar materials.

Storage stability:

May be kept indefinitely if stored properly. If an expiry date is mentioned on the packaging/label this takes priority over the statements on storage duration in this safety data sheet.

8. Exposure Controls and Personal Protection

Advice on system design:

Whenever possible, engineering controls should be used to minimize the need for personal protective equipment.

Personal protective equipment

Respiratory protection:

Wear respiratory protection if ventilation is inadequate. Wear a NIOSH-certified (or equivalent) organic vapour/particulate respirator. For situations where the airborne concentrations may exceed the level for which an air purifying respirator is effective, or where the levels are unknown or Immediately Dangerous to Life or Health (IDLH), use NIOSH-certified full facepiece pressure demand self-contained breathing apparatus (SCBA) or a full facepiece pressure demand supplied-air respirator (SAR) with escape provisions.

Safety Data Sheet

PT® 4 ALLURE

Revision date : 2009/12/23

Version: 1.0

Page: 4/7

(30487965/SDS_GEN_US/EN)

Hand protection:

Chemical resistant protective gloves, Protective glove selection must be based on the user's assessment of the workplace hazards.

Eye protection:

Safety glasses with side-shields. Tightly fitting safety goggles (chemical goggles). Wear face shield if splashing hazard exists.

Body protection:

Body protection must be chosen depending on activity and possible exposure, e.g. head protection, apron, protective boots, chemical-protection suit.

General safety and hygiene measures:

RECOMMENDATIONS FOR MANUFACTURING, COMMERCIAL BLENDING, AND PACKAGING WORKERS

Wear long sleeved work shirt and long work pants in addition to other stated personal protective equipment.

Work place should be equipped with a shower and an eye wash. Handle in accordance with good industrial hygiene and safety practice. Personal protective equipment should be decontaminated prior to reuse. Gloves

must be inspected regularly and prior to each use. Replace if necessary (e.g. pinhole leaks). Take off

immediately all contaminated clothing. Store work clothing separately. Hands and/or face should be washed

before breaks and at the end of the shift. No eating, drinking, smoking or tobacco use at the place of work. Keep

away from food, drink and animal feeding stuffs.

9. Physical and Chemical Properties

Form:	liquid, oily	
Odour:	mild, oily	
Colour:	colourless	
pH value:	approx. 4.6	(1,000 g/l)
Boiling point:	110 °C	(5.33 hPa)
Vapour pressure:	0.16 - 6.9 Pa	(20 °C)
Density:	0.88 - 0.89 g/cm ³	(25 °C)
Solubility in water:		insoluble

10. Stability and Reactivity

Conditions to avoid:

No conditions known that should be avoided.

Substances to avoid:

air, strong oxidizing agents

Hazardous reactions:

The product is chemically stable.

Decomposition products:

No hazardous decomposition products if stored and handled as prescribed/indicated., Prolonged thermal loading can result in products of degradation being given off.

Thermal decomposition:

Possible thermal decomposition products:

carbon monoxide, carbon dioxide

Stable at ambient temperature. If product is heated above decomposition temperature toxic vapours may be released. To avoid thermal decomposition, do not overheat.

Corrosion to metals:

Corrosive effects to metal are not anticipated.

11. Toxicological information

Safety Data Sheet

PT® 4 ALLURE

Revision date : 2009/12/23

Version: 1.0

Page: 5/7

(30487965/SDS_GEN_US/EN)

Acute toxicity

Oral:

Type of value: LD50

Species: rat

Value: > 5,000 mg/kg

The statement for acute oral toxicity was derived from products of similar composition.

Inhalation:

Type of value: LC50

Species: rat

Value: > 5 mg/l

The statement for acute inhalative toxicity was derived from products of similar composition.

Dermal:

Type of value: LD50

Species: rat

Value: > 2,000 mg/kg

Irritation / corrosion

Skin:

Species: rabbit

Result: Irritant.

Data of a comparable product

Eye:

Species: rabbit

Result: non-irritant

The product has not been tested. The statement has been derived from products of a similar structure and composition.

Sensitization:

Species: guinea pig

Result: Non-sensitizing.

The product has not been tested. The statement has been derived from products of a similar structure and composition.

12. Ecological Information

Fish

Acute:

static

Oncorhynchus mykiss (96 h): 8.3 mg/l

Aquatic invertebrates

Acute:

static

Daphnia magna/EC50 (48 h): 2.6 mg/l

Aquatic plants

Toxicity to aquatic plants:

static

green algae/EC50 (72 h): 0.3 mg/l

13. Disposal considerations

Waste disposal of substance:

Safety Data Sheet

PT® 4 ALLURE

Revision date : 2009/12/23

Version: 1.0

Page: 6/7

(30487965/SDS_GEN_US/EN)

Do not discharge into waterways or sewer systems without proper authorization. Dispose of in accordance with national, state and local regulations. Dispose of in a licensed facility. Residues should be disposed of in the same manner as the substance/product.

Container disposal:

Completely empty packaging may be treated as household waste. Recommend crushing, puncturing or other means to prevent unauthorized use of used containers. Do not reuse empty containers.

14. Transport Information

Land transport

USDOT

Not classified as a dangerous good under transport regulations

Sea transport

IMDG

Not classified as a dangerous good under transport regulations

Air transport

IATA/ICAO

Not classified as a dangerous good under transport regulations

15. Regulatory Information

Federal Regulations

Registration status:

Chemical TSCA, US released / listed

EPCRA 311/312 (Hazard categories):

Acute;

16. Other Information

Recommended use: insecticide

BASF supports worldwide Responsible Care® initiatives. We value the health and safety of our employees, customers, suppliers and neighbors, and the protection of the environment. Our commitment to Responsible Care is integral to conducting our business and operating our facilities in a safe and environmentally responsible fashion, supporting our customers and suppliers in ensuring the safe and environmentally sound handling of our products, and minimizing the impact of our operations on society and the environment during production, storage, transport, use and disposal of our products.

PT® 4 ALLURE is a registered trademark of BASF Corporation or BASF SE
IMPORTANT: WHILE THE DESCRIPTIONS, DESIGNS, DATA AND INFORMATION CONTAINED HEREIN ARE PRESENTED IN GOOD FAITH AND BELIEVED TO BE ACCURATE, IT IS PROVIDED FOR YOUR GUIDANCE ONLY. BECAUSE MANY FACTORS MAY AFFECT PROCESSING OR APPLICATION/USE, WE RECOMMEND THAT YOU MAKE TESTS TO DETERMINE THE SUITABILITY OF A PRODUCT FOR YOUR PARTICULAR PURPOSE PRIOR TO USE. NO WARRANTIES OF ANY KIND, EITHER EXPRESSED OR

Safety Data Sheet

PT® 4 ALLURE

Revision date : 2009/12/23

Page: 7/7

Version: 1.0

(30487965/SDS_GEN_US/EN)

IMPLIED, INCLUDING WARRANTIES OF MERCHANTABILITY OR FITNESS FOR A PARTICULAR PURPOSE, ARE MADE REGARDING PRODUCTS DESCRIBED OR DESIGNS, DATA OR INFORMATION SET FORTH, OR THAT THE PRODUCTS, DESIGNS, DATA OR INFORMATION MAY BE USED WITHOUT INFRINGING THE INTELLECTUAL PROPERTY RIGHTS OF OTHERS. IN NO CASE SHALL THE DESCRIPTIONS, INFORMATION, DATA OR DESIGNS PROVIDED BE CONSIDERED A PART OF OUR TERMS AND CONDITIONS OF SALE. FURTHER, YOU EXPRESSLY UNDERSTAND AND AGREE THAT THE DESCRIPTIONS, DESIGNS, DATA, AND INFORMATION FURNISHED BY BASF HEREUNDER ARE GIVEN GRATIS AND BASF ASSUMES NO OBLIGATION OR LIABILITY FOR THE DESCRIPTION, DESIGNS, DATA AND INFORMATION GIVEN OR RESULTS OBTAINED, ALL SUCH BEING GIVEN AND ACCEPTED AT YOUR RISK.
END OF DATA SHEET

Safety Data Sheet

PT® 14 ALLURE

Revision date : 2009/12/23

Version: 1.0

Page: 1/7

(30487966/SDS_GEN_US/EN)

1. Product and Company Identification

Company

BASF CORPORATION
100 Campus Drive
Florham Park, NJ 07932, USA

24 Hour Emergency Response Information

CHEMTREC: 1-800-424-9300
BASF HOTLINE: 1-800-832-HELP

Registrant:

Whitmire Micro-Gen Research Laboratories, Inc.
3568 Tree Court Industrial Blvd.
St. Louis, MO 63122

Chemical family: pheromone

2. Hazards Identification

Emergency overview

CAUTION:
KEEP OUT OF REACH OF CHILDREN.
KEEP OUT OF REACH OF DOMESTIC ANIMALS.
HARMFUL IF SWALLOWED.
Avoid contact with the skin, eyes and clothing.
Avoid inhalation of mists/vapours.

State of matter: liquid
Colour: colourless
Odour: mild

Potential health effects**Primary routes of exposure:**

Routes of entry for solids and liquids include eye and skin contact, ingestion and inhalation. Routes of entry for gases include inhalation and eye contact. Skin contact may be a route of entry for liquified gases.

Acute toxicity:

Relatively nontoxic after single ingestion. Slightly toxic after short-term skin contact. Relatively nontoxic after short-term inhalation.

Irritation / corrosion:

May cause slight but temporary irritation to the eyes. May cause moderate irritation to the skin.

Sensitization:

Skin sensitizing effects were not observed in animal studies.

Potential environmental effects

Safety Data Sheet

PT® 14 ALLURE

Revision date : 2009/12/23

Version: 1.0

Page: 2/7

(30487966/SDS_GEN_US/EN)

Aquatic toxicity:

Acutely toxic for fish. Acutely toxic for aquatic invertebrates. Very toxic (acute effect) to aquatic plants.

3. Composition / Information on Ingredients

CAS Number

31654-77-0

Content (W/W)

Chemical name

9,12-Tetradecadien-1-ol, 1-acetate, (9E,12Z)-

4. First-Aid Measures

General advice:

First aid providers should wear personal protective equipment to prevent exposure. Remove contaminated clothing. Move person to fresh air. If person is not breathing, call 911 or ambulance, then give artificial respiration, preferably mouth-to-mouth if possible. Call a poison control center or physician for treatment advice. Have the product container or label with you when calling a poison control center or doctor or going for treatment.

If inhaled:

Remove the affected individual into fresh air and keep the person calm.

If on skin:

Rinse skin immediately with plenty of water for 15 - 20 minutes.

If in eyes:

Hold eyes open and rinse slowly and gently with water for 15 to 20 minutes. Remove contact lenses, if present, after first 5 minutes, then continue rinsing.

If swallowed:

Never induce vomiting or give anything by mouth if the victim is unconscious or having convulsions. Do not induce vomiting. Have person sip a glass of water if able to swallow.

5. Fire-Fighting Measures

Flash point:

110 °C

(Tag closed cup)

Suitable extinguishing media:

foam, dry extinguishing media, carbon dioxide

Hazards during fire-fighting:

carbon monoxide,

If product is heated above decomposition temperature, toxic vapours will be released. The substances/groups of substances mentioned can be released in case of fire.

Protective equipment for fire-fighting:

Firefighters should be equipped with self-contained breathing apparatus and turn-out gear.

Further information:

Evacuate area of all unnecessary personnel. Contain contaminated water/firefighting water. Do not allow to enter drains or waterways.

6. Accidental release measures

Personal precautions:

Take appropriate protective measures. Clear area. Shut off source of leak only under safe conditions. Extinguish sources of ignition nearby and downwind. Ensure adequate ventilation. Wear suitable personal protective clothing and equipment.

Safety Data Sheet

PT® 14 ALLURE

Revision date : 2009/12/23

Version: 1.0

Page: 3/7

(30487966/SDS_GEN_US/EN)

Environmental precautions:

Do not discharge into the subsoil/soil. Do not discharge into drains/surface waters/groundwater. Contain contaminated water/firefighting water. A spill of or in excess of the reportable quantity requires notification to state, local and national emergency authorities. This product is not regulated by CERCLA ('Superfund').

Cleanup:

Dike spillage. Pick up with suitable absorbent material. Spilled substance/product should be recovered and applied according to label rates whenever possible. If application of spilled substance/product is not possible, then spills should be contained, solidified, and placed in suitable containers for disposal. After decontamination, spill area can be washed with water. Collect wash water for approved disposal.

7. Handling and Storage

Handling

General advice:

RECOMMENDATIONS ARE FOR MANUFACTURING, COMMERCIAL BLENDING, AND PACKAGING WORKERS. PESTICIDE APPLICATORS & WORKERS must refer to the Product Label and Directions for Use attached to the product. Provide good ventilation of working area (local exhaust ventilation if necessary). Keep away from sources of ignition - No smoking. Keep container tightly sealed. Protect against heat. Handle and open container with care. Do not open until ready to use. Once container is opened, content should be used as soon as possible. Provide means for controlling leaks and spills. Follow label warnings even after container is emptied. The substance/ product may be handled only by appropriately trained personnel. Avoid all direct contact with the substance/product. Avoid contact with the skin, eyes and clothing. Avoid inhalation of dusts/mists/vapours. Wear suitable personal protective clothing and equipment.

Protection against fire and explosion:

The relevant fire protection measures should be noted. Fire extinguishers should be kept handy. Avoid extreme heat.

Storage

General advice:

Keep only in the original container in a cool, dry, well-ventilated place away from ignition sources, heat or flame. Protect containers from physical damage. Protect against contamination. The authority permits and storage regulations must be observed.

Storage incompatibility:

General advice: Segregate from incompatible substances. Segregate from foods and animal feeds. Segregate from textiles and similar materials.

Storage stability:

May be kept indefinitely if stored properly. If an expiry date is mentioned on the packaging/label this takes priority over the statements on storage duration in this safety data sheet.

8. Exposure Controls and Personal Protection

Advice on system design:

Whenever possible, engineering controls should be used to minimize the need for personal protective equipment.

Personal protective equipment

Respiratory protection:

Wear respiratory protection if ventilation is inadequate. Wear a NIOSH-certified (or equivalent) organic vapour/particulate respirator. For situations where the airborne concentrations may exceed the level for which an air purifying respirator is effective, or where the levels are unknown or Immediately Dangerous to Life or Health (IDLH), use NIOSH-certified full facepiece pressure demand self-contained breathing apparatus (SCBA) or a full facepiece pressure demand supplied-air respirator (SAR) with escape provisions.

Safety Data Sheet

PT® 14 ALLURE

Revision date : 2009/12/23

Version: 1.0

Page: 4/7

(30487966/SDS_GEN_US/EN)

Hand protection:

Chemical resistant protective gloves, Protective glove selection must be based on the user's assessment of the workplace hazards.

Eye protection:

Safety glasses with side-shields. Tightly fitting safety goggles (chemical goggles). Wear face shield if splashing hazard exists.

Body protection:

Body protection must be chosen depending on activity and possible exposure, e.g. head protection, apron, protective boots, chemical-protection suit.

General safety and hygiene measures:

RECOMMENDATIONS FOR MANUFACTURING, COMMERCIAL BLENDING, AND PACKAGING WORKERS

Wear long sleeved work shirt and long work pants in addition to other stated personal protective equipment.

Work place should be equipped with a shower and an eye wash. Handle in accordance with good industrial hygiene and safety practice. Personal protective equipment should be decontaminated prior to reuse. Gloves

must be inspected regularly and prior to each use. Replace if necessary (e.g. pinhole leaks). Take off

immediately all contaminated clothing. Store work clothing separately. Hands and/or face should be washed

before breaks and at the end of the shift. No eating, drinking, smoking or tobacco use at the place of work. Keep

away from food, drink and animal feeding stuffs.

9. Physical and Chemical Properties

Form:	liquid, oily	
Odour:	mild, oily	
Colour:	colourless	
pH value:	approx. 4.6	(1,000 g/l)
Boiling point:	110 °C	(5.33 hPa)
Vapour pressure:	0.16 - 6.9 Pa	(20 °C)
Density:	0.88 - 0.89 g/cm ³	(25 °C)
Solubility in water:		insoluble

10. Stability and Reactivity

Conditions to avoid:

No conditions known that should be avoided.

Substances to avoid:

air, strong oxidizing agents

Hazardous reactions:

The product is chemically stable.

Decomposition products:

No hazardous decomposition products if stored and handled as prescribed/indicated., Prolonged thermal loading can result in products of degradation being given off.

Thermal decomposition:

Possible thermal decomposition products:

carbon monoxide, carbon dioxide

Stable at ambient temperature. If product is heated above decomposition temperature toxic vapours may be released. To avoid thermal decomposition, do not overheat.

Corrosion to metals:

Corrosive effects to metal are not anticipated.

11. Toxicological information

Safety Data Sheet

PT® 14 ALLURE

Revision date : 2009/12/23

Version: 1.0

Page: 5/7

(30487966/SDS_GEN_US/EN)

Acute toxicity

Oral:

Type of value: LD50

Species: rat

Value: > 5,000 mg/kg

The statement for acute oral toxicity was derived from products of similar composition.

Inhalation:

Type of value: LC50

Species: rat

Value: > 5 mg/l

The statement for acute inhalative toxicity was derived from products of similar composition.

Dermal:

Type of value: LD50

Species: rat

Value: > 2,000 mg/kg

Irritation / corrosion

Skin:

Species: rabbit

Result: Irritant.

Data of a comparable product

Eye:

Species: rabbit

Result: non-irritant

The product has not been tested. The statement has been derived from products of a similar structure and composition.

Sensitization:

Species: guinea pig

Result: Non-sensitizing.

The product has not been tested. The statement has been derived from products of a similar structure and composition.

12. Ecological Information

Fish

Acute:

static

Oncorhynchus mykiss (96 h): 8.3 mg/l

Aquatic invertebrates

Acute:

static

Daphnia magna/EC50 (48 h): 2.6 mg/l

Aquatic plants

Toxicity to aquatic plants:

static

green algae/EC50 (72 h): 0.3 mg/l

13. Disposal considerations

Waste disposal of substance:

Safety Data Sheet

PT® 14 ALLURE

Revision date : 2009/12/23

Version: 1.0

Page: 6/7

(30487966/SDS_GEN_US/EN)

Do not discharge into waterways or sewer systems without proper authorization. Dispose of in accordance with national, state and local regulations. Dispose of in a licensed facility. Residues should be disposed of in the same manner as the substance/product.

Container disposal:

Completely empty packaging may be treated as household waste. Recommend crushing, puncturing or other means to prevent unauthorized use of used containers. Do not reuse empty containers.

14. Transport Information

Land transport

USDOT

Not classified as a dangerous good under transport regulations

Sea transport

IMDG

Not classified as a dangerous good under transport regulations

Air transport

IATA/ICAO

Not classified as a dangerous good under transport regulations

15. Regulatory Information

Federal Regulations

Registration status:

Chemical TSCA, US released / listed

EPCRA 311/312 (Hazard categories):

Acute;

16. Other Information

Recommended use: insecticide

BASF supports worldwide Responsible Care® initiatives. We value the health and safety of our employees, customers, suppliers and neighbors, and the protection of the environment. Our commitment to Responsible Care is integral to conducting our business and operating our facilities in a safe and environmentally responsible fashion, supporting our customers and suppliers in ensuring the safe and environmentally sound handling of our products, and minimizing the impact of our operations on society and the environment during production, storage, transport, use and disposal of our products.

PT® 14 ALLURE is a registered trademark of BASF Corporation or BASF SE
IMPORTANT: WHILE THE DESCRIPTIONS, DESIGNS, DATA AND INFORMATION CONTAINED HEREIN ARE PRESENTED IN GOOD FAITH AND BELIEVED TO BE ACCURATE, IT IS PROVIDED FOR YOUR GUIDANCE ONLY. BECAUSE MANY FACTORS MAY AFFECT PROCESSING OR APPLICATION/USE, WE RECOMMEND THAT YOU MAKE TESTS TO DETERMINE THE SUITABILITY OF A PRODUCT FOR YOUR PARTICULAR PURPOSE PRIOR TO USE. NO WARRANTIES OF ANY KIND, EITHER EXPRESSED OR

Safety Data Sheet

PT® 14 ALLURE

Revision date : 2009/12/23

Page: 7/7

Version: 1.0

(30487966/SDS_GEN_US/EN)

IMPLIED, INCLUDING WARRANTIES OF MERCHANTABILITY OR FITNESS FOR A PARTICULAR PURPOSE, ARE MADE REGARDING PRODUCTS DESCRIBED OR DESIGNS, DATA OR INFORMATION SET FORTH, OR THAT THE PRODUCTS, DESIGNS, DATA OR INFORMATION MAY BE USED WITHOUT INFRINGING THE INTELLECTUAL PROPERTY RIGHTS OF OTHERS. IN NO CASE SHALL THE DESCRIPTIONS, INFORMATION, DATA OR DESIGNS PROVIDED BE CONSIDERED A PART OF OUR TERMS AND CONDITIONS OF SALE. FURTHER, YOU EXPRESSLY UNDERSTAND AND AGREE THAT THE DESCRIPTIONS, DESIGNS, DATA, AND INFORMATION FURNISHED BY BASF HEREUNDER ARE GIVEN GRATIS AND BASF ASSUMES NO OBLIGATION OR LIABILITY FOR THE DESCRIPTION, DESIGNS, DATA AND INFORMATION GIVEN OR RESULTS OBTAINED, ALL SUCH BEING GIVEN AND ACCEPTED AT YOUR RISK.

END OF DATA SHEET